

Flush Light Fitting

INSTRUCTION MANUAL

Safety Warnings

- It is recommended that this light be installed by a qualified electrician in accordance with current IEE Wiring Regulations and Building Regulations (Part P).
- This product is only suitable for connection to a 220-240V~50Hz supply and is for indoor use only.
- This light may be installed in “Zones 1 and 2 and Outside Zones” of a bathroom where water jets are not used for cleaning purposes. These zones are referenced in BS 7671: 2008 “Requirements for Electrical Installations”, IEE Wiring Regulations 17th Edition. All dimensions must be checked in conjunction with the Regulations.
- The supply circuit must be protected by an RCD OR the casing of the light must be connected to the “Supplementary Equipotential Bonding” points in the bathroom.
- An electrician must be consulted if in any doubt about your own competency or meaning of bathroom “Zones” or “Equipotential Bonding” or “RCD”.
- This fitting is a Class II, Double Insulated product. The Fitting does not require an Earth, and Live or Neutral must NOT be connected to Earth
- Switch off the mains supply and remove the appropriate fuse or switch off the appropriate circuit breaker before commencing installation.
- This product contains non-replaceable LEDs.
- Clean with a dry cloth only. Do not use liquid or abrasive cleaners on this product, and allow 10 minutes to cool before replacing adjusting or cleaning.
- If any modification is made it will invalidate the warranty and may render the product unsafe.
- If the glass or diffuser is broken or cracked it must be replaced, please consult your retailer. This is the

symbol which denotes this requirement:

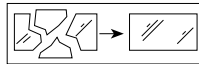

Zone Information

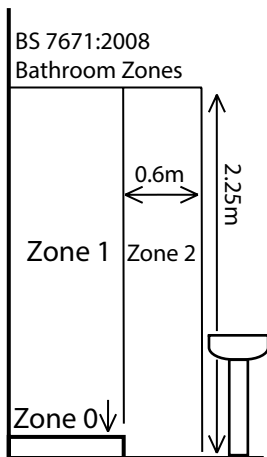

Shower tray shown; bath has equivalent diagram.
Refer to Standard for more information.

Basins should be regarded as having a 600mm Zone 2 hemisphere above and extending down to floor.

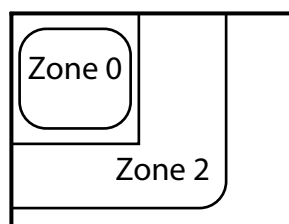

Assembly/ User Instructions

Before you start

Please read these instructions carefully before fitting and retain for reference.

Check the packaging and make sure that you have all the required parts.

Follow each assembly step in order to prevent incorrect assembly.

Ensure that the product is fully assembled as illustrated before use.

The Light pack contains:

Light fitting.

Terminal connection block(s).

Fixing pack.

The following tools may be required:

Selection of cross and flat head screwdrivers.

Electric drill and assorted drill bits.

Wire strippers.

Electrical insulation tape.



UK Manufacturer: BH17 7BY
EU Manufacturer: Brilliant AG,
Brilliantstrasse 1, D-27442 Gnarrenburg

Assembly/ User Instructions Continued

Please note - This instruction covers the 3 and 5 light version of these products.

These assembly diagrams are intended as a guide – if in doubt consult a qualified electrician.

1. Decide on the position of the light fitting / or remove existing light fitting. Take a note of the position of the electrical connections. Ensure there is a solid mounting surface, preferably a wooden joist or joist bridge to support the weight of the light fitting.
2. Remove the three bracket screws, and retain for future use. Use the fixing bracket as a template to mark the screw holes, and secure to the ceiling with appropriate screw fixings (Diagram 1).
3. **Diagram 2:** Support your fitting and connect the house wiring to the terminal block inside insulated terminal box – see expanded wiring details below. **NOTE: This is a Class II fitting and must not be earthed.** If you have any earth cables make sure that they are connected to each other – to maintain earth continuity throughout your property – and wrap the earth terminal and connections in 2 layers of good quality insulation tape and keep them away from the terminal connections of the fitting. The ‘loose’ terminal block connector supplied can be used for the “loop” wires of the “Ring Circuit”. There may be more than one set of cables in the “loop” connections. This terminal should be outside the fitting and wrapped in 2 layers of good quality insulation tape. **If there is a “Ring Circuit” and you do not understand the connections you must consult an electrician.** Close the terminal box (D) ensuring no wires are damaged, trapped or left exposed. Check the seal, use sealant if required
4. **Diagram 3:** Secure the ceiling cup (A) inside the bracket by using the screws (B) removed in Point 2.
5. Turn on the power and test.

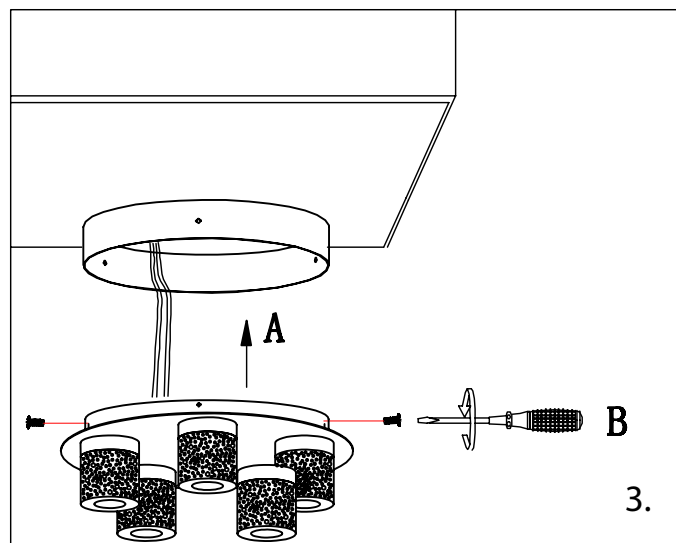
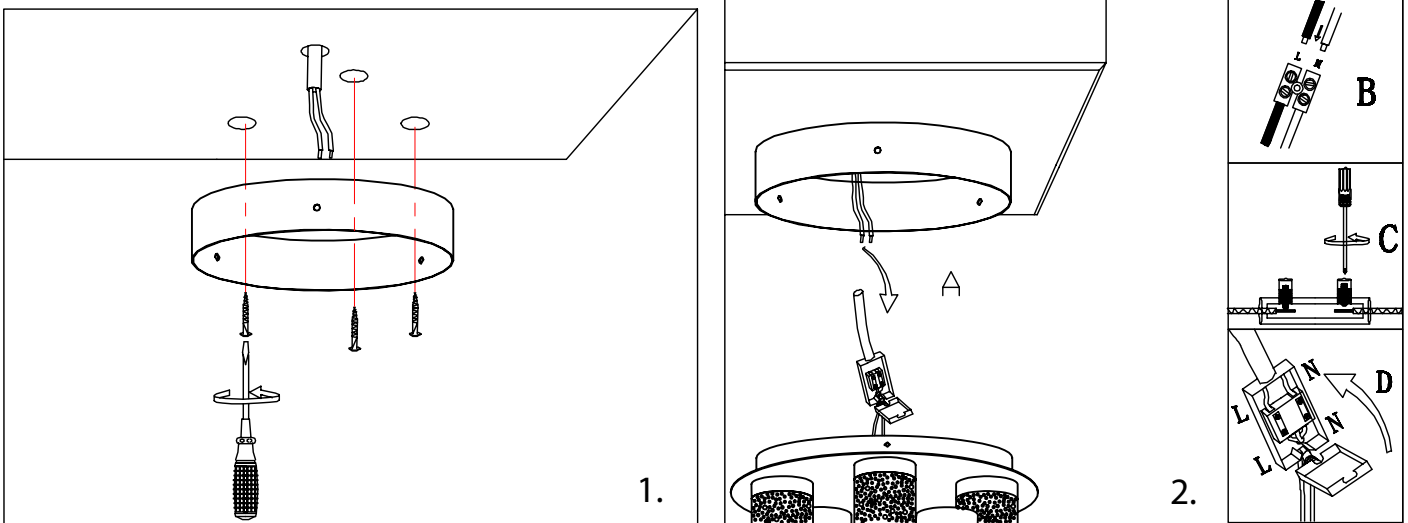

- EN Scan QR code for multi-language
- FR Scannez le code QR pour plusieurs langues
- ES Escanee el código QR para varios idiomas
- PL Zeskanuj kod QR dla wielu języków
- DE Scannen Sie den QR-Code nach mehreren Sprachen
- IT Scansiona il codice QR per multilingua



UK Manufacturer: BH17 7BY
EU Manufacturer: Brilliant AG,
Brilliantstrasse 1, D-27442 Gnarrenburg