

Wall Light

INSTRUCTION MANUAL

Safety Warnings

- This product is only suitable for connection to a 240V~50Hz supply in accordance with current IEE wiring regulations. It should be installed in accordance with local building regulations and is for domestic indoor use only. It is not suitable for a bathroom or outdoor location.
- Before installing your light fitting always switch off the mains supply and remove the appropriate fuse or switch off the appropriate circuit breaker before commencing installation.
- This is a Class I product and **must** be connected to Earth. The terminal blocks are supplied according to requirements of the fitting.
- Never fit bulbs of a higher wattage than those specified on the label, as these may damage the fitting.
- This product contains delicate parts – be careful during handling and maintenance to avoid breakage.
- If you are in any doubt about your competence please consult a qualified electrician.
- If any modification is made it will invalidate the warranty and may render the product unsafe.
- This product is dimmable when used with a dimmable bulb.

Care Information

Allow 10 minutes to cool before replacing, adjusting or cleaning.

Clean with a dry cloth only. Do not use liquid or abrasive cleaners on this product.

Assembly/ User Instructions

Before you start

Please read these instructions carefully before fitting and retain for reference. Check the packaging and make sure that you have all the required parts. Follow each assembly step in order to prevent incorrect assembly. Ensure that the product is fully assembled as illustrated before use.

The Light pack contains:

Light fitting.
Terminal connection block(s).
Fixing pack
3 x Glass panels.

The following tools may be required:

Selection of cross and flat head screwdrivers.
Electric drill and assorted drill bits.
Wire strippers.
Electrical insulation tape.

These assembly diagrams are intended as a guide – if in doubt consult a qualified electrician.

1. Decide on the position of the light fitting, or remove existing light fitting. Take a note of the position of the electrical connections. Ensure there is a solid mounting surface, preferably a wooden joist or joist bridge to support the weight of the light fitting.
2. Refer to Fig. 1. Detach the wall back (A) from the shade frame (B) by removing the screw (C) from underneath the fitting. Keep safe for refitting later. Use the wall back (A) as a template to mark the screw holes, and secure to the wall with appropriate screw fixings (D), making sure the wall back is correctly aligned.
3. Refer to Fig. 2. Undo the two screws (E) under the lampholder (F) and set aside. Support your fitting and connect the house wiring to the terminal block (G) - see expanded wiring diagram. When you are sure of the connections wrap the terminal block and overlap the wiring both sides with 2 layers of insulation tape. **NOTE: This is a Class I fitting and must be earthed.** Once complete, refit the screws (F) set aside earlier.
4. Refer to Fig. 2. Fit the bulb (H). **NOTE: Never fit bulbs of a higher wattage than those specified on the label (as these may cause overheating and damage the fitting).**
5. Refer to Fig. 3. Fit the glass panels (I) into the shade frame, ensuring that the tabs hold the glass securely.
6. Refer to Fig. 4. Place the assembled glass box (J) flush onto the wall back (A) and secure in place by refitting the screw (C) set aside earlier.
7. Turn on the power and test.

Fig. 1

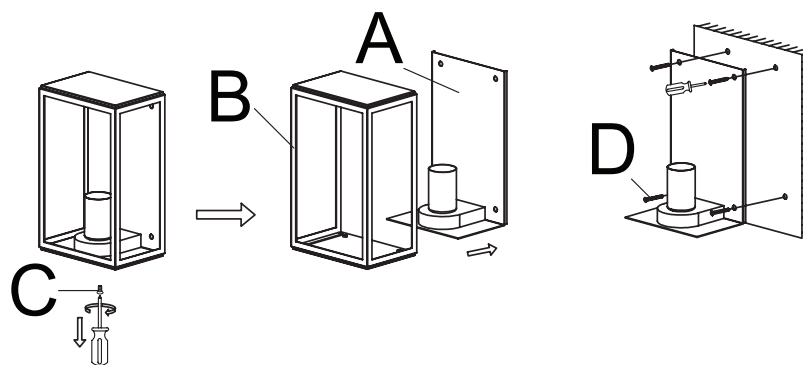

Fig. 2

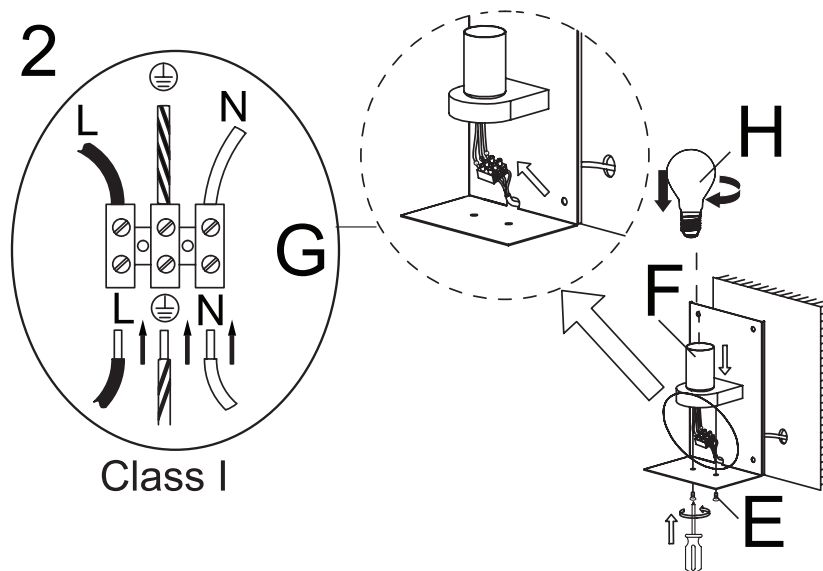

Fig. 3

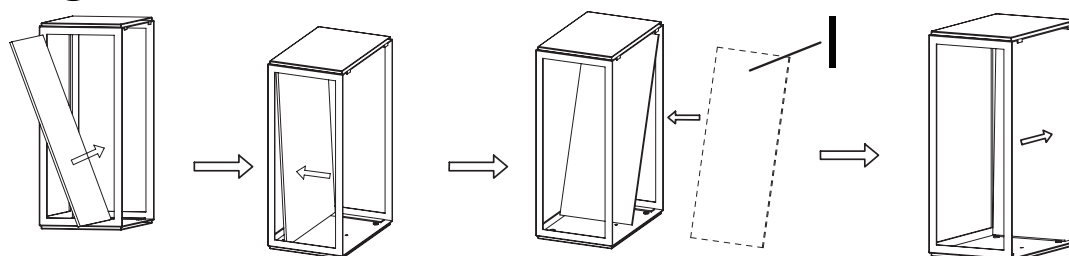
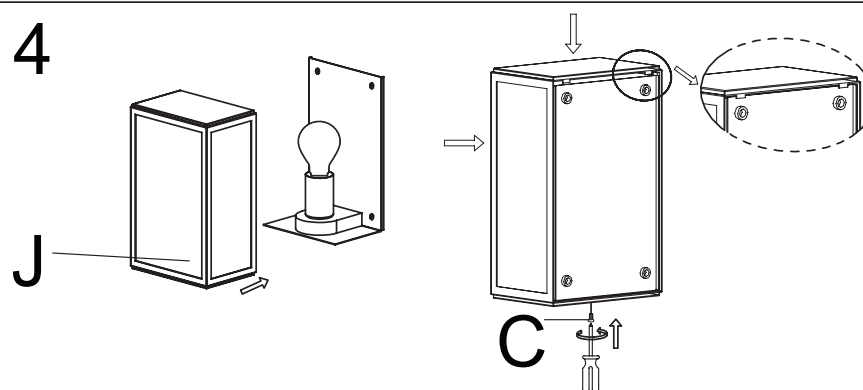

Fig. 4



(EN) Scan QR code for multi-language
 (FR) Scannez le code QR pour plusieurs langues
 (ES) Escanee el código QR para varios idiomas
 (PL) Zeskanuj kod QR dla wielu języków
 (DE) Scannen Sie den QR-Code nach mehreren Sprachen
 (IT) Scansiona il codice QR per multilingua



UK Manufacturer: BH17 7BY
 EU Manufacturer: 1 Gnarrenburg, 27442