

Installation and Safety Instructions

Pendant Light Fitting

Safety Warnings

- This product is only suitable for connection to a 240V~50Hz supply in accordance with current IEE wiring regulations, and should be installed in accordance with local Building Regulations. They are for domestic, indoor ceiling use only, and are **not** suitable for a Bathroom location.
- The light fitting should be connected to a lighting circuit protected by a 5 amp fuse (or a 6 amp miniature circuit breaker).
- Before installing your light fitting always switch off the mains supply, and remove the appropriate fuse or switch off the appropriate circuit breaker before commencing installation. Ensure that no one else has access that would enable the supply to be inadvertently reconnected.
- **This is a Class 1 product and must be Earthed.** The terminal blocks are supplied according to requirements of the fitting.
- Never fit bulbs of a higher wattage than those specified on the label, as these may cause overheating and damage the fitting.
- This product is suitable for dimming when used with dimmable bulbs.
- If you are in any doubt about your competence please consult a qualified electrician.
- If any modification is made it will invalidate the warranty and may render the product unsafe.

Care Information

Allow 10 minutes to cool before replacing, adjusting or cleaning.

Clean with a dry cloth only. Do not use liquid or abrasive cleaners on this product.

Assembly/ User Instructions

Before you start

Please read these instructions carefully before fitting and retain for reference.

Check the packaging and make sure that you have all the required parts. Follow each assembly step in order to prevent incorrect assembly. Ensure that the product is fully assembled as illustrated before use.

The Light pack contains:

Light fitting.
Fixing pack.

The following tools may be required:

Selection of cross and flat head screwdrivers.
Electric drill and assorted drill bits.
Wire strippers.

These assembly diagrams overleaf are intended as a guide – if in doubt consult a qualified electrician.

1. Decide on the position of the light fitting / or remove existing light fitting. Take a note of the position of the electrical connections. Ensure there is a solid mounting surface, preferably a wooden joist or joist bridge to support the weight of the light fitting.
2. Loosen the screws (B) and remove the mounting bracket (A) from the fitting. Using the screws and wall plugs (C) supplied in the fixing pack, secure the mounting bracket to the ceiling, taking care to avoid damaging any concealed wiring.
3. Height adjustment: This will be easier to complete before attaching the product to the ceiling. Work out the new height at which the product will hang. Support the weight of the fitting and loosen the screw (D). Then adjust the cable clamp (E). Carefully loosen the screw on the cable clamp in the ceiling cover. Feed the cable through the clamp and into the ceiling cover. When the desired length of cable is reached, retighten the clamp and then retighten the screw.

Assembly/ User Instructions Continued

- Support your fitting and connect the house wiring to the terminal blocks (F) – see expanded wiring details below. **NOTE: This is a Class I product and must be earthed.**
- Secure the product to the mounting bracket (A) by locating the screws (B) through the holes in the ceiling cover and tightening the screws.
- Place the shade (G) onto the lampholder and secure in place by fitting the shade ring (H). Do not overtighten.
- Fit the bulb (I - not supplied). **NOTE: Never fit bulbs of a higher wattage than those specified on the label, as these may cause overheating and damage the fitting.**
- Turn on the power and test.

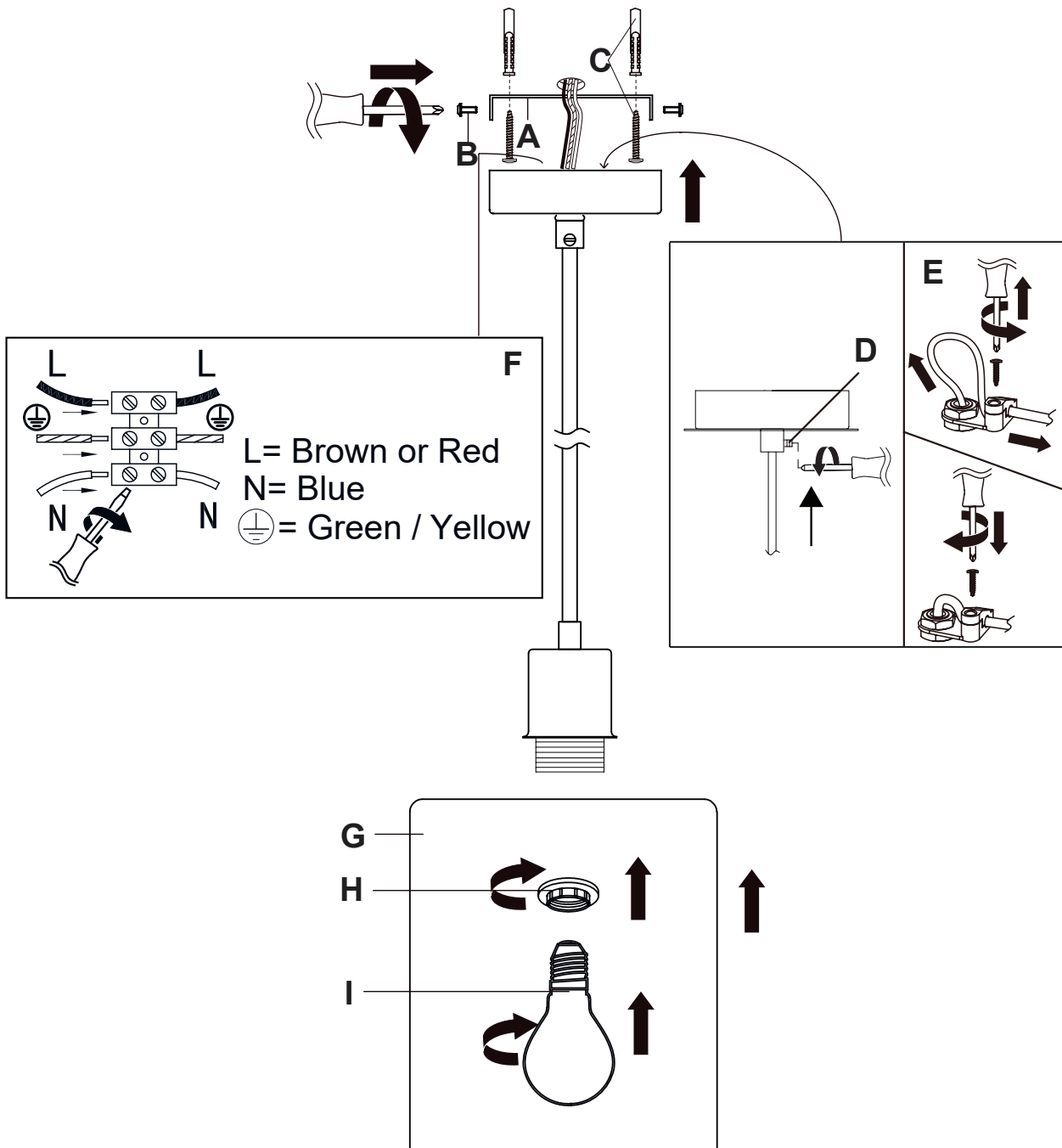

- (EN) Scan QR code for multi-language
- (FR) Scannez le code QR pour plusieurs langues
- (ES) Escanee el código QR para varios idiomas
- (PL) Zeskanuj kod QR dla wielu języków
- (DE) Scannen Sie den QR-Code nach mehreren Sprachen
- (IT) Scansiona il codice QR per multilingua



UK Manufacturer: BH17 7BY
 EU Manufacturer: Brilliant AG,
 Brilliantstrasse 1, D-27442 Gnarrenburg