

### INSTRUCTION MANUAL

Please read these instructions carefully before using your new light and retain for reference.

#### Safety Warnings

Do not plug into the mains until your lamp is fully assembled. Under no circumstances must this floor lamp be covered with any material as this could pose a safety hazard.

This product is not suitable for persons under 14 years of age.

This product is only suitable for connection to 240V~50Hz supply, indoor use only and is *not* suitable for a Bathroom location.

The Floor Lamp must be protected by a 3 amp fuse in the mains plug.

If the mains plug requires replacing use a plug approved to BS1363 and wire it up according to the appropriate diagram below – use Diagram A for a class I (Earthed) product and Diagram B for a class II (Double insulated) product.

This product is supplied without a shade but before use a suitable shade must be fitted. This should not be of a size / shape that will impair the stability of the fully assembled product.

If any modification is made it will invalidate the warranty and may render the product unsafe.

If the mains cable becomes damaged it must only be replaced by a technically competent, qualified person.

#### Assembly/ User Instructions

- Carefully unpack your Floor Lamp.
- Place your Floor lamp on a stable, flat surface.
- Fit your chosen shade (1) by unscrewing shade ring (2) from the lamp holder, positioning the shade (1) and replacing the shade ring.
- Install the Bulb (3). Do not install a bulb with a greater wattage or different shape than specified on the label.
- Plug in and operate the switch (may be either a lamp holder or an in-line switch).

If your Floor Lamp will not illuminate, please check the bulb, the 3 amp fuse in the plug and ultimately check the relevant fuse in your Fuse Box.

If unsuccessful please consult your Retailer.

Switch off, remove plug and allow 10 minutes to cool before replacing bulb(s) or cleaning using only a dry cloth.

**NOTE:** This generic diagram is intended as guidance only and not an exact representation of a specific model.

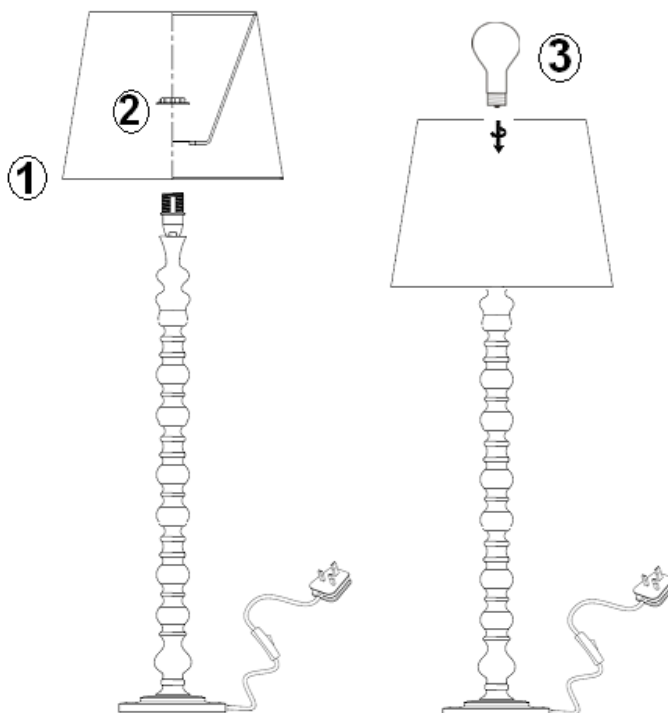

**DIAGRAM A (Class I)**

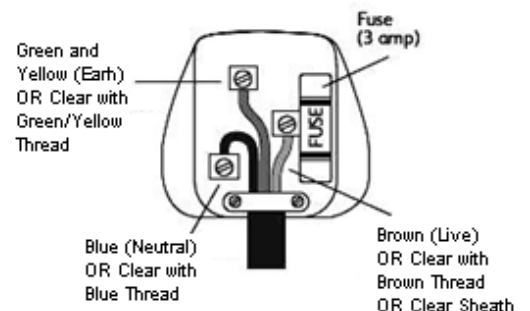

**DIAGRAM B (Class II)**

